

Tous droits strictement réservés. Reproduction ou communication a des tiers interdite sous quelque forme que ce soit sans autorisation écrite du propriétaire. Propriété de c FCI. Droits de reproduction FCI.

All rights strictly reserved. Reproduction or issue to third parties in any form whatever is not permitted without written authority from the proprietor. Property of FCI. Copyright FCI.

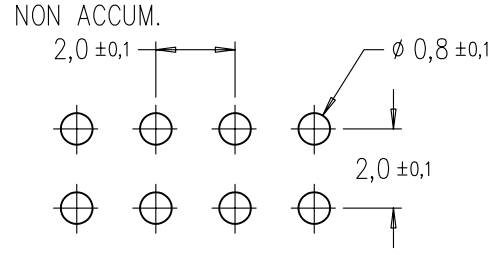

RECOMMENDED MOUNTING HOLE LAYOUT

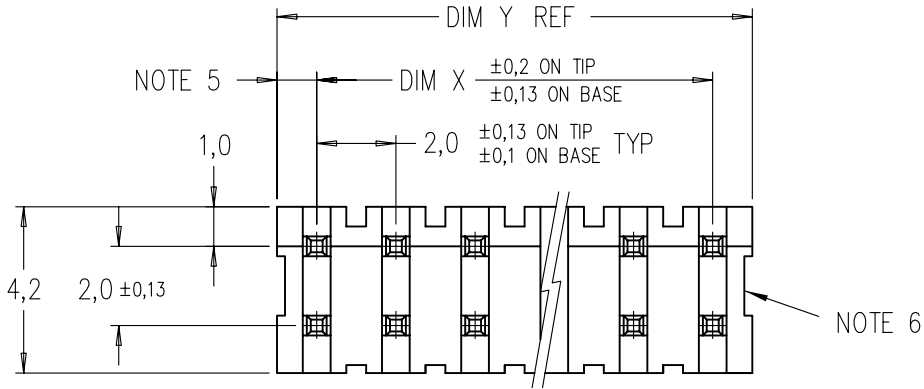
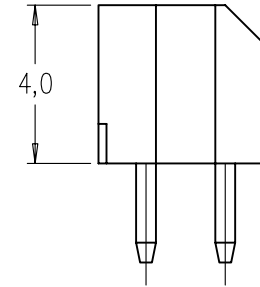
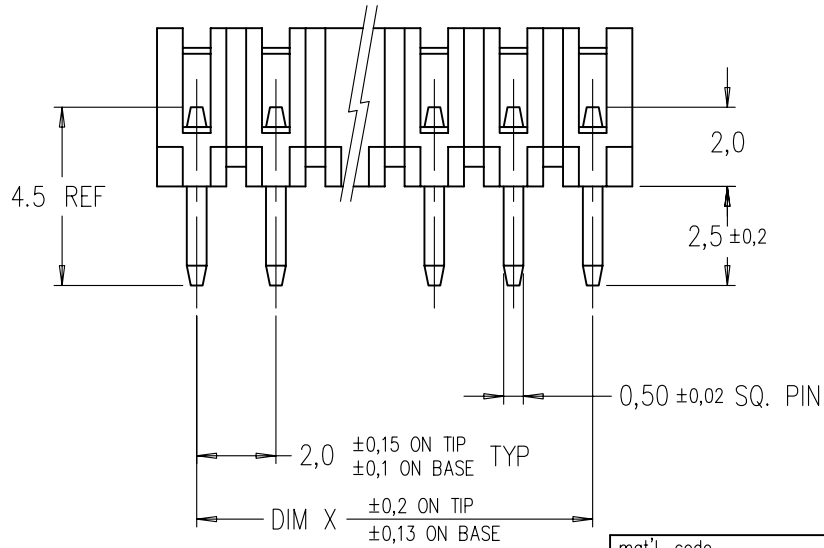

CONFIDENTIAL

mat'l. code				tolerances unless otherwise specified				CUSTOMER COPY		FCI www.fciconnect.com	
ltr	ecn no	dr	date	linear	± 0.25			projection	title MINITEK II 2.0 MM HOLDING HEADER		
A	S40256	BSL	10/24/94								
B	S05-0064	KBM	3/1/05	angles				MM	product family MINITEK		code
				dr	ML CHWA	10/24/94	scale 10:1		size dwg no		sheet
				enrg	BS LOW	10/27/94		A	94268		1 of 2
				chr	KB MAH	3/1/05					
				appd	JOEY NG	3/1/05					
sheet index	revision sheet	B	B								
		1	2								

cage code 22526

ACAD

PDM: Rev:B

STATUS Released

Printed Jul 20, 2005

Tous droits strictement reserves. Reproduction ou communication a des tiers interdite sous quelque forme que ce soit sans autorisation ecrite du propriétaire. Propriete de c FCI. Droits de reproduction FCI.



All rights strictly reserved. Reproduction or issue to third parties in any form whatever is not permitted without written authority from the proprietor. Property of FCI. Copyright FCI.

1 | 2

3 |

4

PRODUCT NO ⑦	POS	DIM X	DIM Y
94268-X04	2X2	2	4
X06	2X3	4	6
X08	2X4	6	8
X10	2X5	8	10
X12	2X6	10	12
X14	2X7	12	14
X16	2X8	14	16
X18	2X9	16	18
X20	2X10	18	20

PLATING	DESCRIPTION
0	0.2um Au OVER Ni
1	0.76um Au OVER Ni
3	0.38um Au OVER Ni
5	0.38um PdNi W Au FLASH OVER Ni
6	0.76um PdNi W Au FLASH OVER Ni

NOTES

- 1 MATERIAL
BODY : G.F. NYLON UL94V-0 BLACK
PIN : COPPER ALLOY
- 2 TOLERANCE UNLESS OTHERWISE NOTED ±0,25
- 3 HEADER BODY TO BE REMOVED AFTER SOLDERING
- 4 PIN TO HOUSING RETENTION FORCE 200 gm MAX. PER PIN AFTER SUBJECTION TO SOLDER TEMPERATURE AT 260°C FOR 5 sec.
- 5 DIM 1.0 APPLIES TO MOLDED SIDE(S) ONLY. IF SIDE(S) ARE SAW, DIM 0.5 MIN APPLIES.
- 6 RECESS APPLIES TO MOLDED SIDE(S) ONLY.

- ⑧ P/N:94268-XXXLF IS SAME AS P/N:94268-XXX. THE SUFFIX 'LF' IS ADDED JUST FOR EASY LEAD FREE IDENTIFICATION
- 9 THE HOUSING WILL WITHSTAND EXPOSURE TO 260° C PEAK TEMPERATURE FOR 10 SECONDS IN A WAVE SOLDER APPLICATION WITH A 1.57MM MINIMUM THICK CIRCUIT BOARD.
- ⑩ THIS PRODUCT MEETS EUROPEAN UNION DIRECTIVES AND OTHER COUNTRY REGULATIONS AS DESCRIBED IN GS-22-008.

⑦ PRODUCT DESCRIPTION CODE :

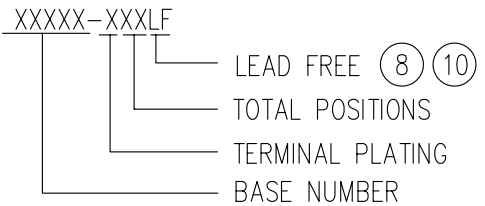

CONFIDENTIAL

mat'l. code				tolerances unless otherwise specified				CUSTOMER COPY		FCI www.fciconnect.com	
ltr	ecn no	dr	date	linear	±0.25			projection	title		
B									MINITEK II 2.0 MM HOLDING HEADER		
				angles				MM	product family		code
				dr	ML CHWA	10/24/94	←		MINITEK		-
				engr	BS LOW	10/27/94	→		size		sheet
				chr	KB MAH	3/1/05	scale		A		2 of 2
				appd	JOEY NG	3/1/05	1:1		94268		
sheet index	revision sheet										

cage code 22526

ACAD

PDM: Rev:B

STATUS Released

Printed Jul 20, 2005

1 | 2

3 |

4